

RETAIL DEVELOPMENT

Anchor & Two PADs

CAVE CREEK RD

DIXILETA DR

56TH ST

64TH ST



TATUM BLVD

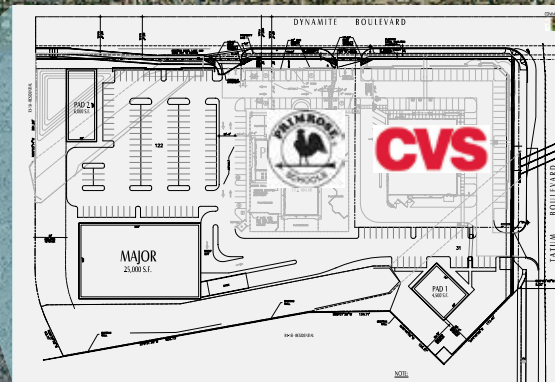

DYNAMITE BLVD

JOMAX RD

SWC Tatum Blvd & Dynamite Road

Phoenix, Arizona

Scott Boardman

Associate Vice President

+1 602 224 4446

Scott.Boardman@cushwake.com

2375 E. Camelback Rd, Suite 300
Phoenix, Arizona 85016

ph: +1 602 954 9000

fx: +1 602 468 8588

cushmanwakefield.com





Property Features:

Location: Tatum Blvd & Dynamite Road

APN: 212-18-201

Size: ±4.1 Acres (±178,207 SF)

Zoning: C1, City of Phoenix

Features: Retail Development
Anchor and Two PADs

Traffic Counts:

Dynamite Blvd 13,292 VPD

Tatum Blvd 21,027 VPD

2012 CoStar

Demographics: 1 Mile 3 Mile 5 Mile

Avg HH Income \$112,857 \$115,581 \$118,600

Population 6,403 23,924 61,119

2013 Esri

SWC Tatum Blvd & Dynamite Road

Phoenix, Arizona

Scott Boardman

Associate Vice President

+1 602 224 4446

Scott.Boardman@cushwake.com

2375 E. Camelback Rd, Suite 300
Phoenix, Arizona 85016

ph: +1 602 954 9000

fx: +1 602 468 8588

cushmanwakefield.com



Conceptual Site Plan:

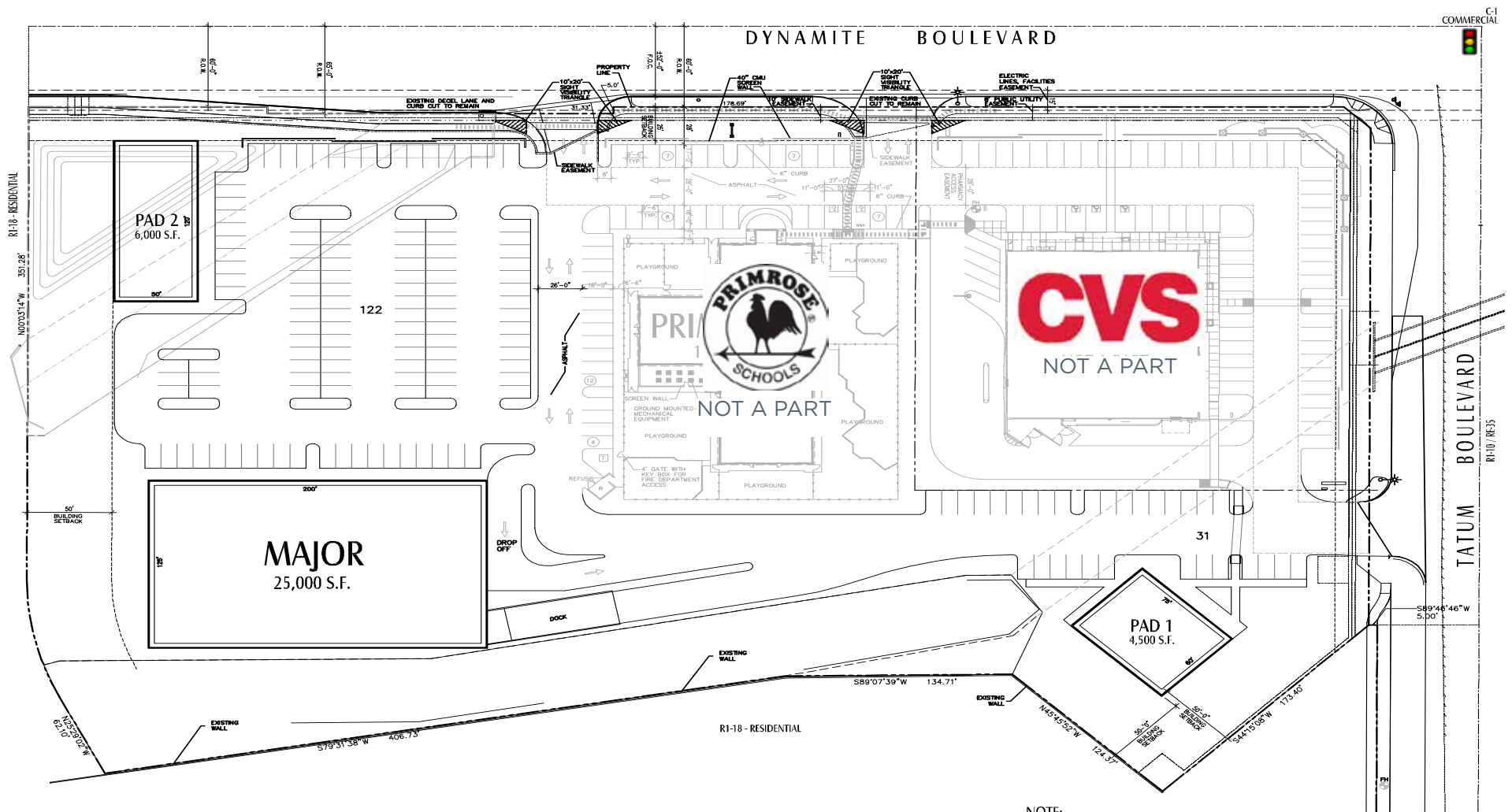

SWC Tatum Blvd & Dynamite Road Phoenix, Arizona

Scott Boardman
Associate Vice President
+1 602 224 4446
Scott.Boardman@cushwake.com

2375 E. Camelback Rd, Suite 300
Phoenix, Arizona 85016
ph: +1 602 954 9000
fx: +1 602 468 8588
cushmanwakefield.com



The information contained herein was obtained from sources we consider reliable. We cannot be responsible, however, for errors, omissions, prior sales, withdrawal from the market or change in price. Seller and broker make no representation as to the environmental condition of the property and recommend purchaser's independent investigation.

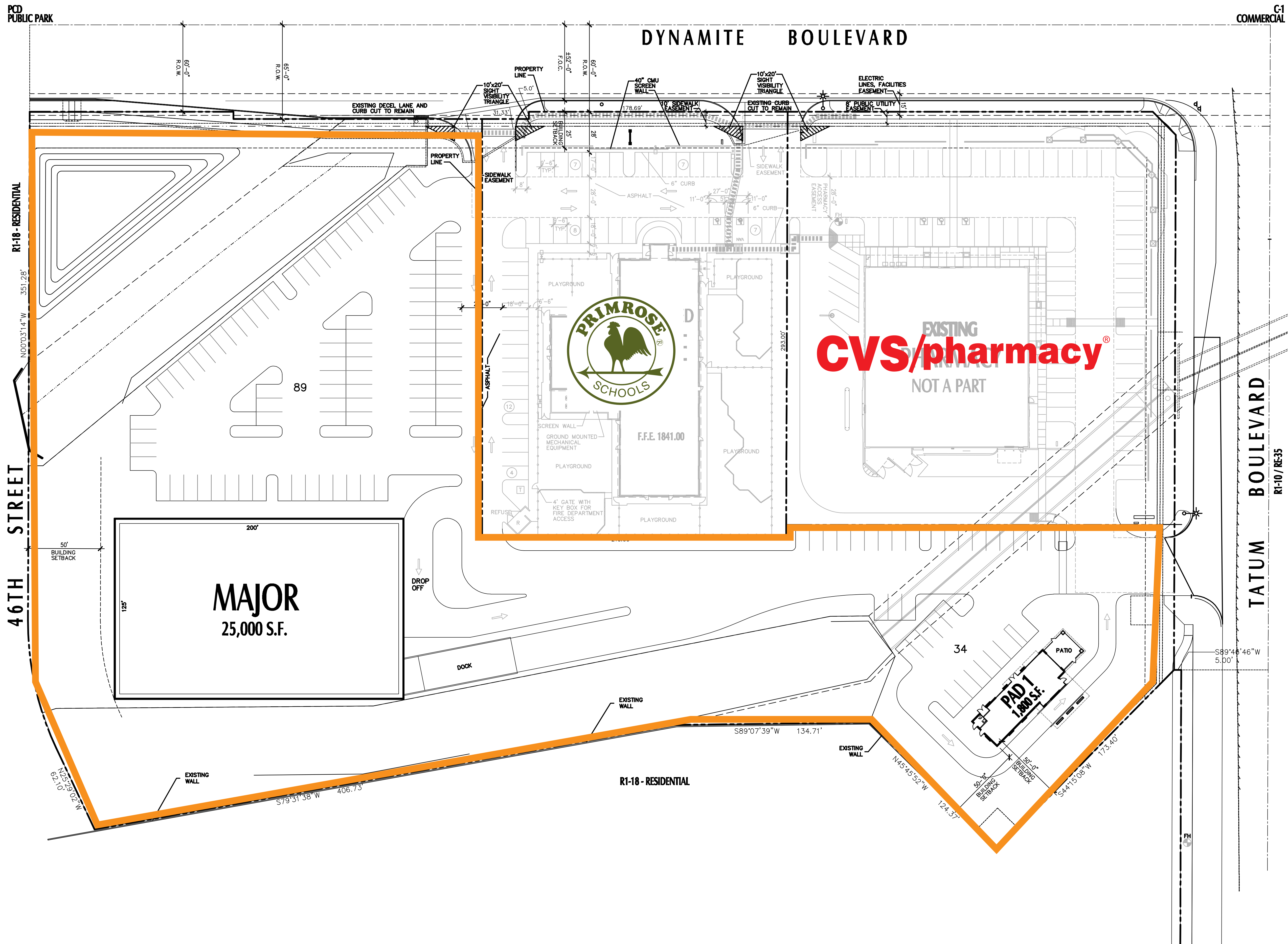

PROJECT DATA

EXISTING ZONING	C-1
GROSS SITE AREA	217,957 SQ. FT. = 5 ACRES
NET SITE AREA	145,566 SQ. FT. = 3.34 ACRES
COVERAGE	
BUILDING AREA	26,800 SQ. FT.
PARKING AREA REQUIRED	105 SP
PROVIDED	123 SP

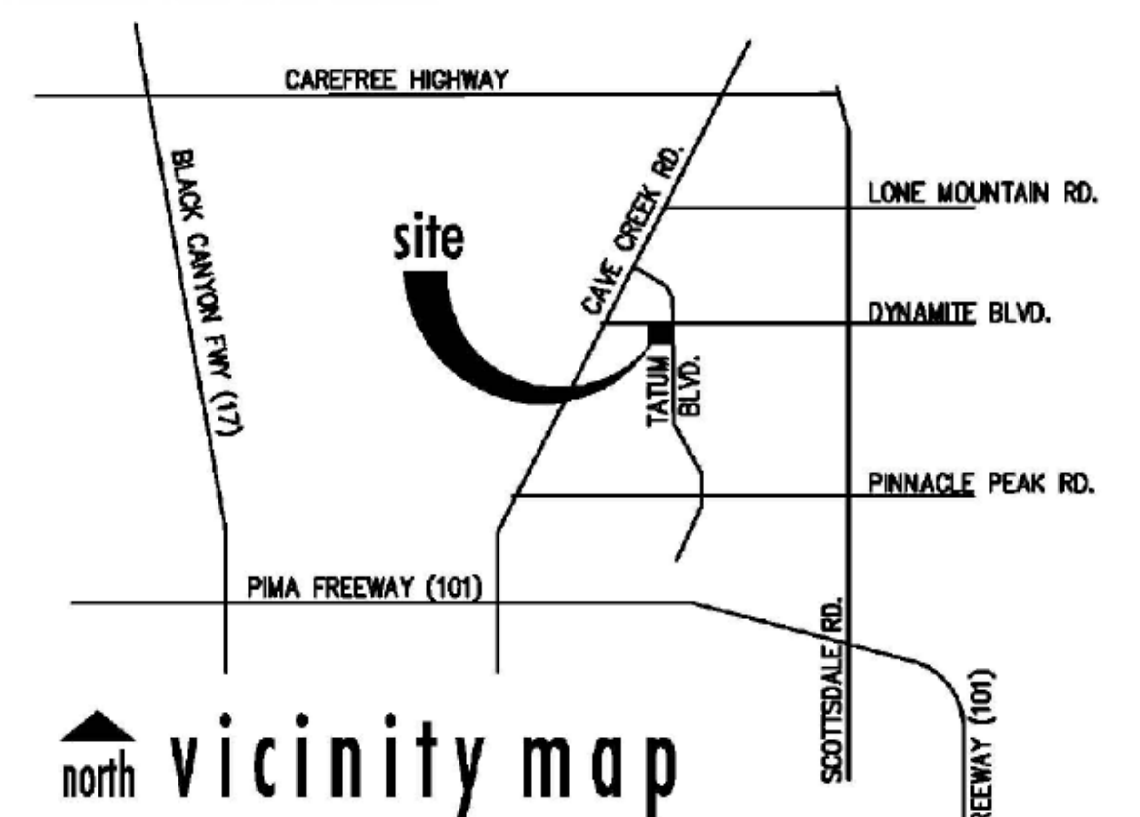

LEGEND

scale: 1" = 40'-0"

copyright 2012 201200

28 APRIL 2014

ESB
ELLERMANN SCHICK & BRUNO
architecture & planning

- ADA PEDESTRIAN PATH
- ACCESSIBLE PARKING SPACE
- REFUSE ENCLOSURE
- OFF-SITE STREET LIGHT
- ON-SITE STREET LIGHT
- FIRE HYDRANT
- TRANSFORMER