

Layout is schematic only and is subject to review & approval by governing agencies. Property line and existing conditions are from GIS information and has not been confirmed.

**SITE DATA**

SITE AREA	PARCELA	±1.72 AC
	PARCEL B	±1.54 AC
BUILDING	PARCELA	6,210 SF, C-STORE
	PARCEL B	824 SF - QSR
PARKING	PROVIDED	
	PARCELA	25 SPACES
	PARCEL B	11 SPACES

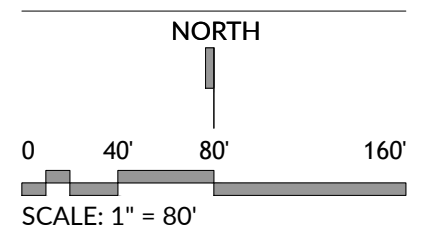
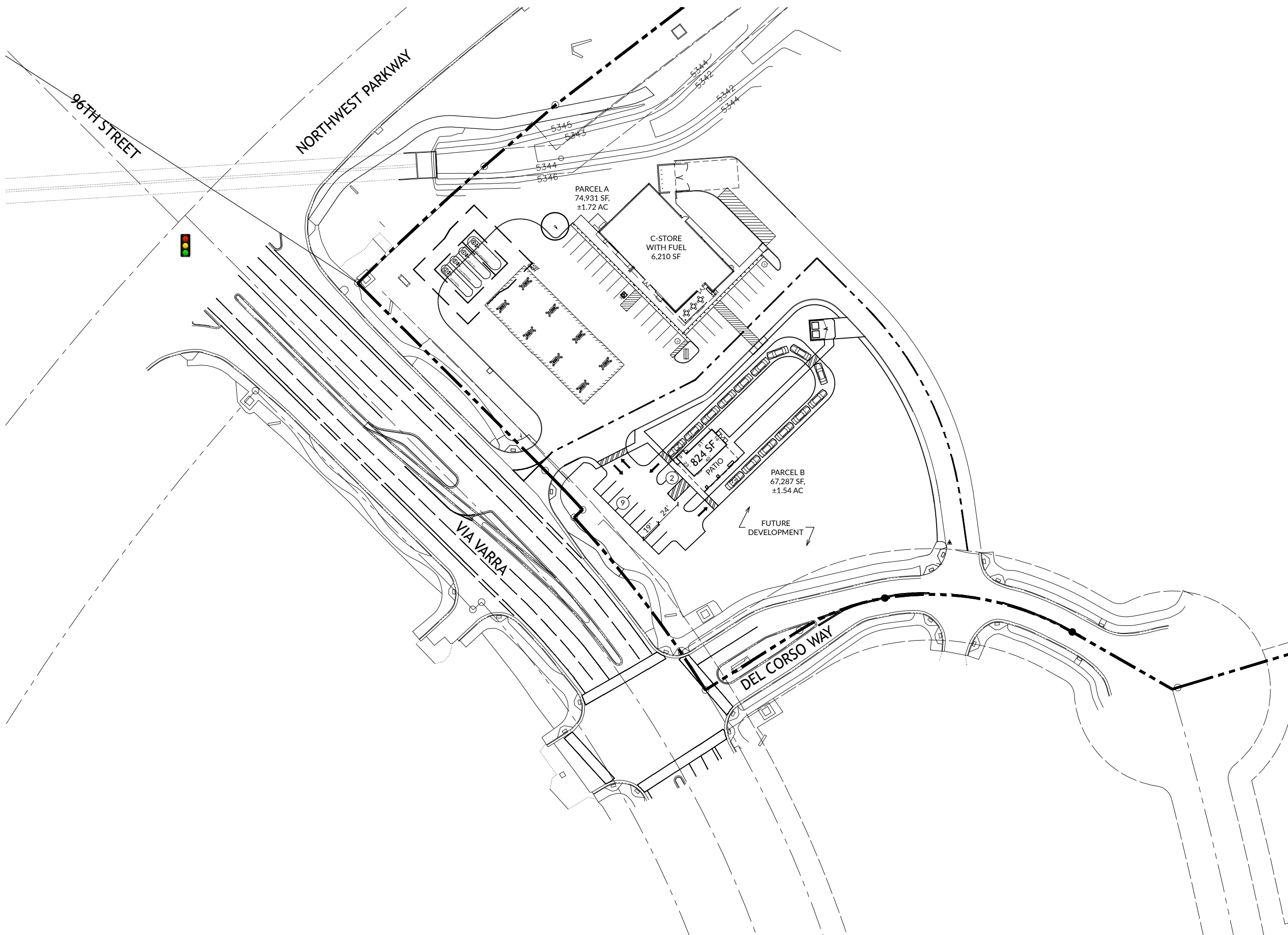

client  
 **Evergreen**  
Development | Services | Investments  
1873 S. Bellaire Street  
Suite 1106  
Denver, Colorado 80222  
(303) 324-9189  
Erika Shorter

project  
**BROOMFIELD,  
COLORADO  
NORTHWEST PARKWAY AND  
VIA VARRA**

drawing title  
**PROPOSED  
SITE PLAN**

date	drawing no.
10.11.2017	1